

# Segnalatori Luminosi $\phi$ 6

## Serie 24.4/24.5



### Serie 24.4/24.5

- Voltaggio: da 110V a 400V
- Temperatura ambiente: da T90 °C a T150 °C
- Dima:  $\phi$  6 mm
- Spessore del pannello: 0.5 - 2.0 mm
- c us

### Terminali

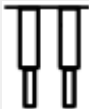

### Dimensioni (mm)

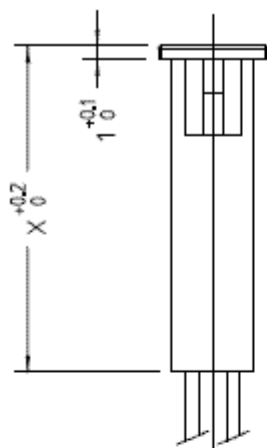

24.4

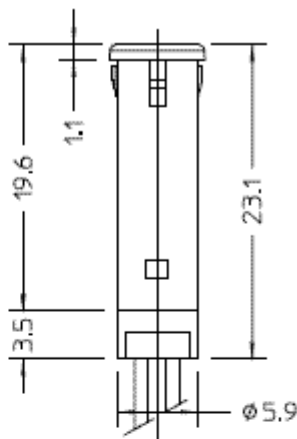

24.5

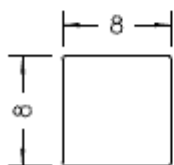

X = 24 mm

