

MOS

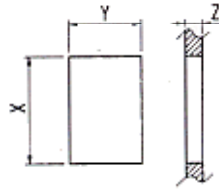

Z	Y	X
0.7±1.25	13 ±0.1	19 ±0.2
1.25±2	13 ±0.1	19.3±0.2
2±3	13 ±0.1	19.5±0.2

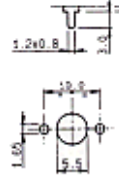
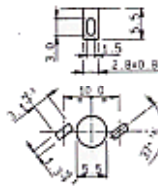

0

5

8

4

?



0

0

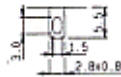

0

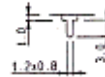

2

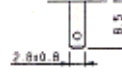

4

0

5

8

4



?



0

0



0-2-4



4



0-2

2(1)A/250V~
1(0.5)A/250V -5E4
T120 °C

2A/125-250VAC

T65 °C

2

6(4)A/250V~
5(2)A/250V -5E4
T120 °C

6A/125-250VAC
1/6HP-250VAC
1/8HP-125VAC
T65 °C

4

10(4)A/250V~
5(2)A/250V -5E4
T120 °C

6A/125-250VAC
1/6HP-250VAC
1/8HP-125VAC
T65 °C

6



