

SERIE RFit / *RFit Series*

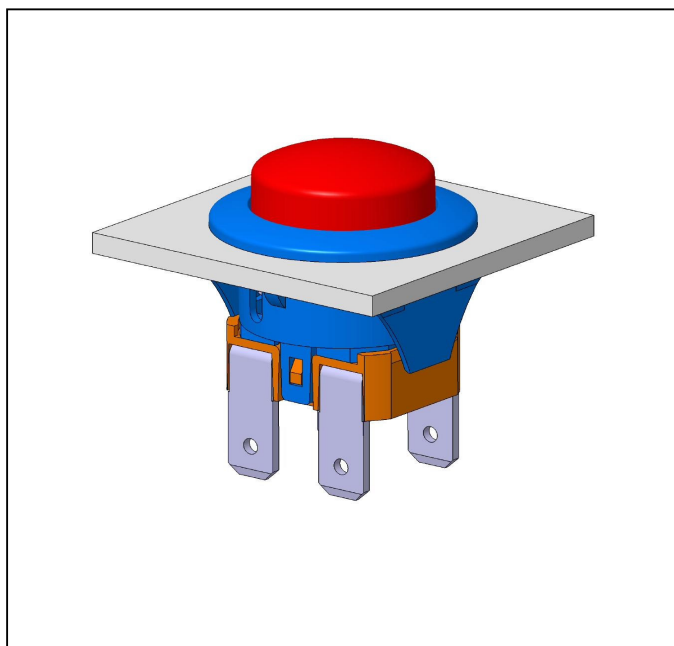

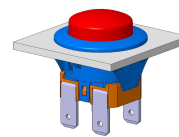

SERIE RFit / RFit Series

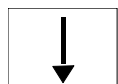
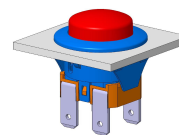

Schemi elettrici disponibili
Wiring diagrams available

	Interruttore unipolare <i>Single-pole switch</i>	Pag. 16
	Interruttore bipolare <i>Double-pole switch</i>	Pag. 16
	Pulsante unipolare <i>Single-pole momentary switch</i>	Pag. 16
	Pulsante bipolare <i>Double-pole momentary switch</i>	Pag. 16
	Interruttore bipolare luminoso <i>Illuminated double-pole switch</i>	Pag. 16

Caratteristiche elettriche Electrical features

Portata <i>Electrical rating</i>	Up to 16(6) A
Numero cicli elettromeccanici <i>Electro-mechanical cycles number</i>	Fino a 50.000 <i>Up to 50.000</i>
Temperatura ambiente <i>Room temperature</i>	125/55°
Infiammabilità <i>Flammability</i>	UL 94 V-2
Resistenza al calore e al fuoco <i>Heat and fire resistance</i>	GWIFI 850 °C GWIT 775 °C (category D)
Distanza tra i contatti <i>Contact gap</i>	≥ 3mm
Marchi di approvazione <i>Approval Marks</i>	
Normative di riferimento <i>Reference Standards</i>	EN61058-1 UL1054

Dima / Cut Out: 20 mm

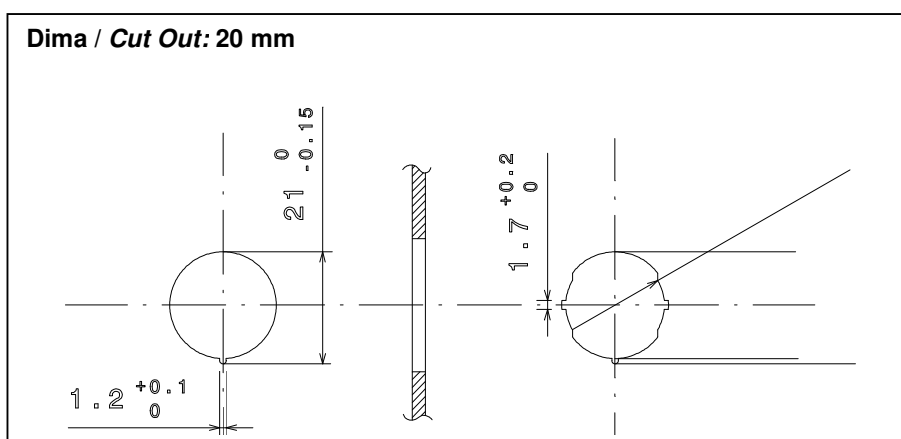

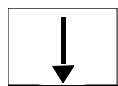

SERIE RFit / RFit Series

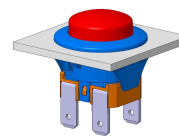



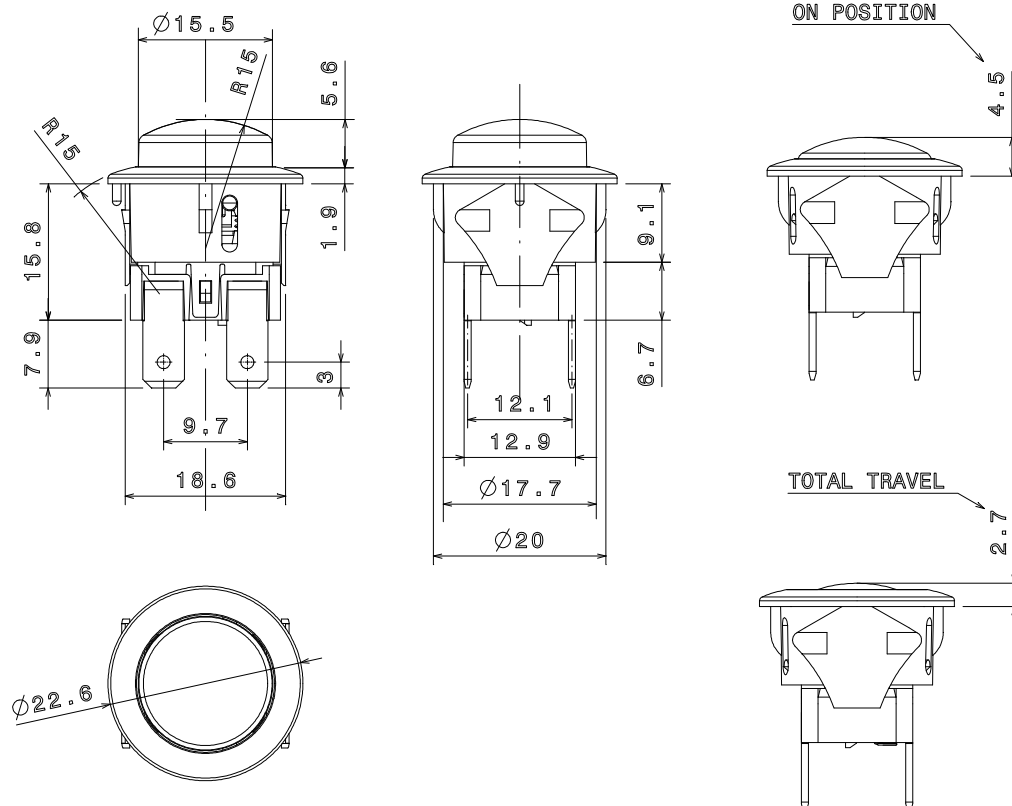

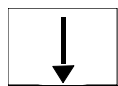

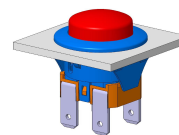

Dimensioni e tipologie di terminali Dimensions and terminal types

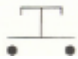

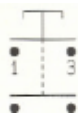

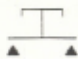
SERIE RFit / RFit Series

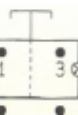
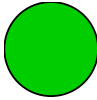
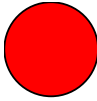

Portata Rating	Schema Wiring diagram	Tasto Push-button	Codice P/N Code
<p>16 (6) A / 250VAC 12 (10) A / 250VAC 8(8) 250V 5E4 T120/55 °C</p> <p>16A – 125 VAC 1/3 HP – 125 VAC T 105°C</p>	<p>Interruttore unipolare <i>Single-pole switch</i></p> 		RFIT121C1100000
	<p>Interruttore bipolare <i>Double-pole switch</i></p> 		RFIT122C1100000
	<p>Pulsante unipolare <i>Single-pole momentary switch</i></p> 		RFIT124C1100000
	<p>Pulsante bipolare <i>Double-pole momentary switch</i></p> 		RFIT127C1100000
	<p>Interruttore bipolare luminoso <i>Illuminated double- pole switch</i></p> 		RFIT128C1E00000
			RFIT128C1G00000

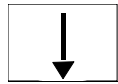

SERIE RFit / RFit Series

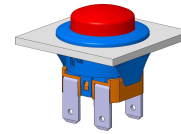

RFit	XX	X	C	X	X	XX	000	
								Marcatura/Engraving
								Colore tasto/ <i>Colour of the rocker</i> 1: nero/black 2: bianco/white 9: rosso/red G: rosso/red E: verde/green H: arancione/orange B: blu/blue
								Colore corpo/ <i>Body colour</i> 1: nero/black 2: bianco/white
								Portata/ <i>Rating</i> 16(6)A 250V 1E3 12(10)A 250V 8(8) A 250 V 5E4 16A 125V UL
								Schema elettrico/ <i>Electric scheme</i> 1: interruttore unipolare/ <i>single-pole switch</i> 2: interruttore bipolare/ <i>double-pole switch</i> 4: pulsante unipolare/ <i>single-pole momentary switch</i> 6: pulsante bipolare/ <i>double-pole momentary switch</i> 8: interruttore bipolare luminoso/ <i>illuminated double-pole switch</i>
								Contatti/ <i>Terminals</i> 11: faston 6,3 mm 90°/ <i>6,3 mm 90° quick connection</i> 12: faston 4,8 mm 90°/ <i>4,8 mm 90° quick connection</i> 13: PIN doppio/ <i>double PIN</i> 21: tasto personalizzabile + faston 6,3 mm 90°/ <i>customizable push-button + 6,3 mm 90° quick connection corpo</i> 22: tasto personalizzabile + faston 4,8 mm 90°/ <i>customizable push-button + 4,8 mm 90° quick connection</i> 23: tasto personalizzabile+ PIN doppio/ <i>customizable push-button + double PIN</i> 31: forma arrotondata + faston 6,3 mm 90°/ <i>roundshape push-button + 6,3 mm 90° quick connection</i> 32: forma arrotondata + faston 4,8 mm 90°/ <i>roundshape push-button + 4,8 mm 90° quick connection</i> 33: forma arrotondata + PIN doppio/ <i>roundshape push-button + double PIN</i>